



baja designs[®]
THE SCIENTISTS OF LIGHTING

**2024 Kawasaki KRX A-Pillar Kit
(44-7193, 44-7192, 44-7191, 44-7190)**



2950 Norman Strasse San Marcos, CA 92069

Phone 760-560-2252 X3 • Fax 760-560-0383

info@bajadesigns.com • www.bajadesigns.com



baja designs[®]
THE SCIENTISTS OF LIGHTING

LIMITED LIFETIME WARRANTY

Baja Designs proudly offers a LIFETIME WARRANTY against manufacturer's defect on all the products that we manufacture.

These are comprehensive warranties; other than the exclusions below – you're covered. If your LED or HID bulb burns out, you're covered. Additionally, cutting off our connector or changing your lenses does not automatically void your warranty.

Exclusions:

Installation errors, abuse, misuse, or crash damage. You must be the original owner of the product and can supply proof of purchase.

Baja Designs manufactures its own products as well as resells products manufactured by others. Baja Designs makes no express or implied warranties on products not manufactured by Baja Designs including without limitation any warranties or merchantability and fitness for a purpose. We will, however, pass on all warranties made by the manufacturer, who has sole responsibility for performing such warranties.

Baja Designs will pay the freight if your product is less than 90 days old, otherwise defective products must be returned to Baja Designs, Inc., freight prepaid. At our option, we will repair or replace items in question and return them at no charge. If the identical product is no longer available, we will replace it with a similar product of equal value. Baja Designs Inc. will not be responsible for any indirect or consequential damages in connection with defective merchandise.

Items purchased through a Baja Designs authorized dealer must be returned through the dealer. Only available on LED auxiliary lights and product must be in sellable condition at MSRP. Product that has been damaged in any way after the original purchase date will be excluded from this guarantee.

Indemnification:

Buyer hereby acknowledges off-roading, racing and driving at night are dangerous activities and that the products and/or supplies purchased from Baja Designs are used in an inherently dangerous activity that may endanger life and limb; and in no event shall the seller, or seller's heirs and assigns, be held liable for consequential damages, nor shall seller's liability on any claim for damages arising out of or connected with the sale, delivery, or use of purchased products and/or supplies exceed the purchase price of the products and/or supplies.

Buyer is responsible for ensuring that it uses the products (and its vehicle) in accordance with all applicable laws, regulations, guidelines, and standards of care. Buyer acknowledges that some products may only be used when off-roading, and Buyer will comply with all vehicle and road safety guidelines. Buyer is solely responsible for (and will indemnify and hold Bestop harmless for) any claims, losses, damages, fines, fees, costs, or other amounts arising out of Buyer's non-compliance with these provisions.

****For a color copy of instructions, visit your vehicle specific application on BajaDesigns.com ****

Parts List:

Required Tool(s):

- 5mm Hex Key
- 10mm, 19mm Socket
- 9/16", 7/16" wrench
- Phillips Screwdriver
- Pry Tool / Flat head screwdriver
- Diagonal Cutters



(44-9450) (Qty: 1)
2024-On, Kawasaki,
Teryx, KRX A-Pillar
Mounting Bracket, Driver
Side



(44-9451) (Qty: 1)
2024-On, Kawasaki,
Teryx, KRX A-Pillar
Mounting Bracket,
Passenger Side



(64-0310) (Qty: 1)
Wiring Harness, Can-Am,
Maverick R, XL A-Pillar
Kit Harness



(56/50/67-0003) (Qty: 2)
XL Pair
(Sport / Pro / 80)



(50-8160) (Qty: 2)
XL (Pro & Sport), Spot
Lens



(50-8162) (Qty: 2)
XL (Pro & Sport), Wide
Cornering Lens



(64-0175) (Qty: 1)
Wiring Harness, Can-Am,
Maverick R, LP4 A-Pillar
Kit Harness



(29-0003) (Qty: 2)
LP4 Pro, LED,
Driving/Combo



(299208) (Qty: 1)
LP4, IPT Reflector Cover,
kit

To begin, make sure the vehicle is in park, on level ground and the parking brake is engaged.

Step 1: Remove the Windshield

Remove the windshield by removing the two button head screws at the front using a 5mm Hex Key. Remove the rubber straps where the screw mounts too.

The windshield will not be able to be used with this A-Pillar Light Kit.

Some trims may not have windshield option

Step 2: A-Pillar Screw Removal

Remove the two screws that connect the A-Pillar to the frame at the base of the windshield using a 19mm socket and ratchet. Only perform on one side at a time.

NOTE: Use Caution, A-Pillar Tube and Lower frame will become misaligned when screws are removed.



Step 3: A-Pillar Bracket Install

With the screws removed, align the bracket and reinstall the two screws at the base of the light

Tips to help with realigning the frame members:

- A second person can help align the holes between the frame members.
- Alternatively, carefully use a small pry tool or screwdriver in the lower mounting hole to help align the frame members. Take care not to damage the internal threads.

Before fully tightening, ensure that the bracket is level. Fully tighten the two screws. Perform on both sides.



Step 4: Remove Center of Dash Fasteners

- Remove the two screws at the base of the center section of the dashboard using a Phillips head screwdriver.
- Remove the two securing plastic push pin clips at the top of the center dash section.



Step 5: Remove Center of Dash

- Disconnect electrical connectors to fully remove the center section



Step 6: Install Electrical Connectors at Power Bus Bar

- Locate the three power studs in the center of the dash and install the harness.
 - o On the leftmost power stud (closest to the driver's side), use a 10mm socket and ratchet to remove the flange nut. With the nut removed, install the yellow wire from the harness and reinstall the nut.
 - o On the center power stud, use a 10mm socket and ratchet to remove the flange nut. With the nut removed, install the red wire from the harness and reinstall the nut.
 - o On the rightmost power stud (closest to the passenger side), use a 10mm socket and ratchet to remove the flange nut. With the nut removed, install the black wire from the harness and reinstall the nut.

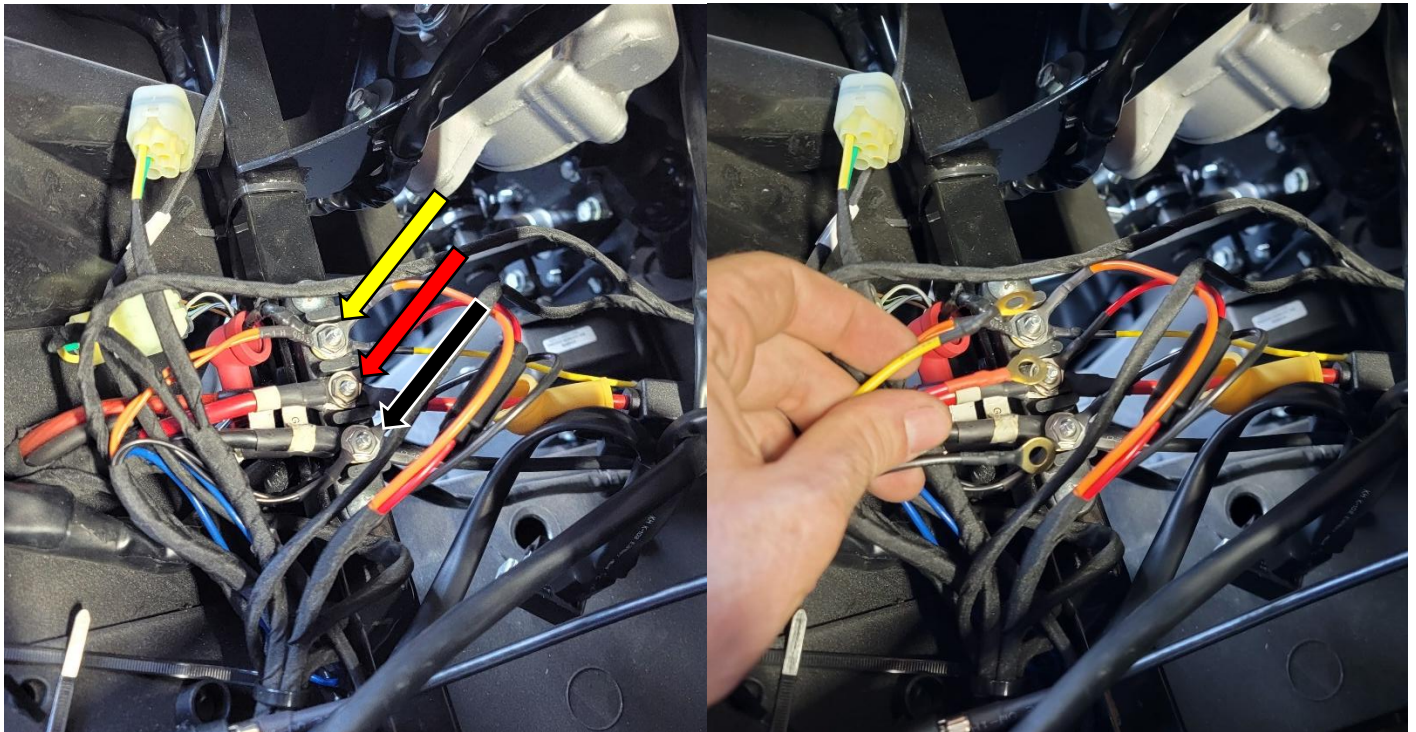

Step 7: Route Electrical Cables to Lights

- Run the unpinned sections of the harness behind the dash to the opening at the base of both A-Pillars.

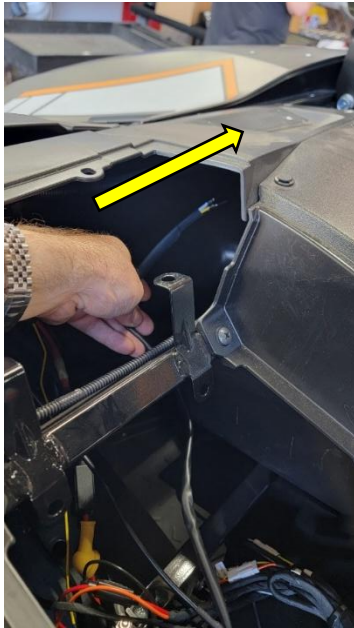

LP4 Only: Once the wires are through the opening, install the pins into the provided Deutsch connector using the following pinout:

Using a flathead screwdriver, remove the green cover on the front of the Deutsch connector. Insert the wires into the positions labeled below until it clicks into place and replace the cover. Repeat for the other light. Tie all excess wire into a service loop.

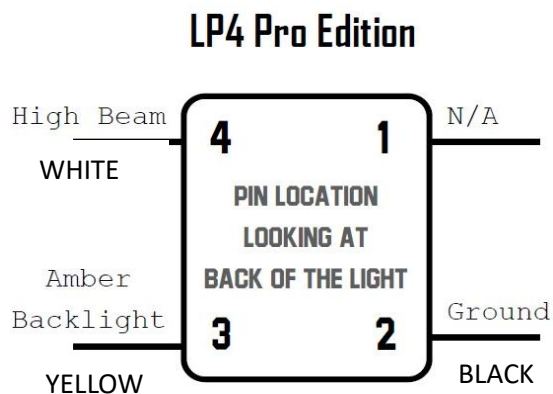

XL Only: Reinstall the pins in the weather pack connector in the following order:

- A = Black / Ground
- B = White / Power
- C = Green / Backlight or Dim

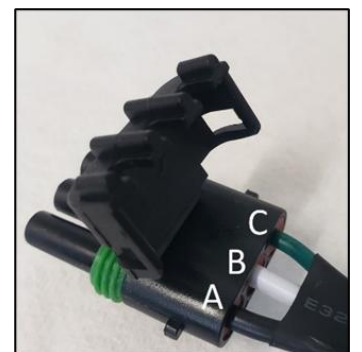

Step 8: Install Switches in Dash

- Push out one of the rocker switch blanks in the center dash section that was removed and install the provided using a mini flat head screwdriver.
- Disconnect the rocker switch from the harness.
- Install the provided rocker switch into the opening.
- Connect the rocker switch to the harness. Tie loose wires into a service loop.
- Reinstall the center dash into the vehicle by reconnecting the electrical components and installing the screws and plastic push pins. (Reverse steps 4 and 5)



Step 9: Install Lights onto Bracket

- Install the Light using the provided universal bracket to the previously installed A-Pillar bracket.
 - o Install the universal bracket to the A-Pillar bracket using a 9/16" wrench to install the center 3/8 bolt, nut and washers. Leave bolts slightly loose.
 - o Use a 7/16" wrench to install the two adjustment 1/4-20 screws, nuts and washers on either side of the main mounting bolt. Leave bolts slightly loose.
 - o Install the light to the universal bracket using the 4 provided 1/4 – 20 screws and washers with a 7/16" wrench on the sides. Leave loose.
 - o Adjust the light to the desired position and secure all fasteners.

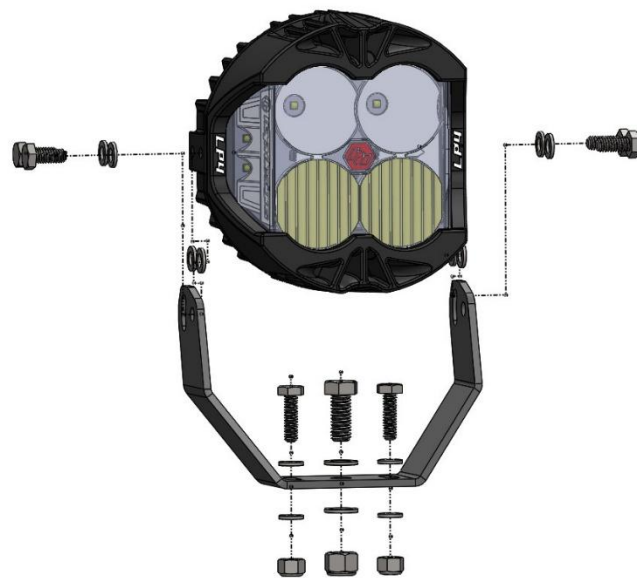

Step 10: LP4 only, install IPT Covers on inside edge of lights

- Peel back the white side of the sticker. Apply the white side of the sticker to the IPT cover.

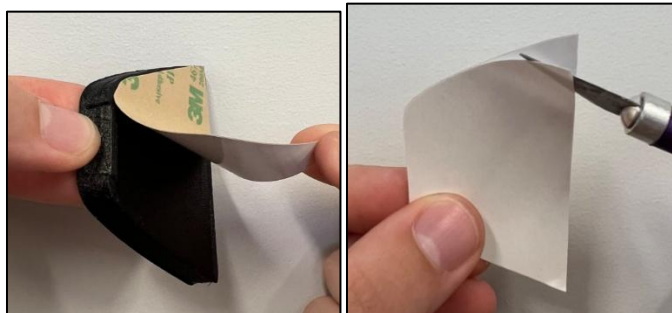

- Once sticker is applied to the IPT cover, peel back the brown 3M side of the sticker. Before applying the IPT cover to the inside of the lens.
- Push the IPT cover to the edges of the light housing then apply pressure to the IPT cover to secure the cover to the lens. (this light will be mounted on your passenger side)
- Only apply IPT covers to inside of the lights.

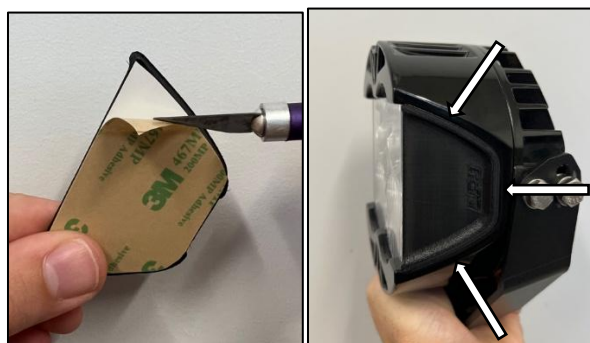

- Repeat for the other light. Be sure to apply your covers as shown in the photo.

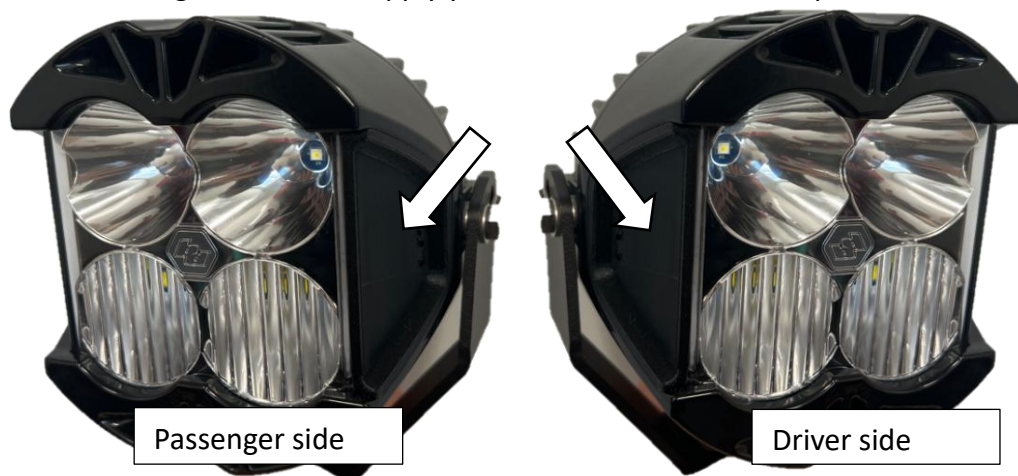

*Tie all wires away from sharp, hot, and/or rotating components.

* Re-torque all the fasteners after 100 miles.

*Your install is now complete! Thank you for choosing Baja Designs.